

# MOBILHOMES DESCRIPTIONS From 24m<sup>2</sup> to 34m<sup>2</sup>

## NO-AIR CONDITIONING

Stay in 7 nights in high season and from 2 nights in low season

All our mobile homes are equipped with a covered terrace and a television

### FAMILIAL « EMERALD » - 24m<sup>2</sup> - 4 persons - TV

the +++: its layout

**2 Bedrooms** – One room with a double bed of 140cm and one room with twin beds of 80cm.

**Kitchen** - Refrigerator + Freezer, equipped kitchen, microwave and kitchen kit.

**Stay** - Bench, table and chairs.

**Bathroom** - Shower + sink. Separated toilets.

**Outside** – Outside terrace of 20m<sup>2</sup> with garden furniture's and eating space



Locations : 213 / 412 / 617 / 626 / 632 / 634 / 677 / 684

### COMFORT « GARNET » - 24m<sup>2</sup> - 5 persons - TV

the +++: its reception capacity

**2 Bedrooms** – One room with a double bed of 140cm and one room with twin beds of 80cm.

**Kitchen** - Refrigerator of 230L + Freezer, equipped kitchen, microwave and kitchen kit.

**Stay** - Bench, table and chairs.

**Bathroom** - Shower + sink. Separated toilets.

**Outside** – Outside covered terrace of 20m<sup>2</sup> with garden furniture's and eating space



Locations : 219 / 607 / 611 / 612 / 635 / 651 / 652 / 653 / 655 / 679 / 685 / 686 / 687 / 741

### GREAT COMFORT « RUBY » - 28m<sup>2</sup> - 5 persons - TV

the +++: its surface of 28m<sup>2</sup>

**2 Bedrooms** – One room with a double bed of 140cm and one room with twin beds of 80cm and an elevated bed of 80cm.

**Kitchen** – Refrigerator of 230L + Freezer, equipped kitchen, microwave and kitchen kit.

**Stay** - Bench, table and chairs.

**Bathroom** - Shower + sink. Separated toilet

**Outside** – Outside terrace of 20m<sup>2</sup> with garden furniture and eating space.

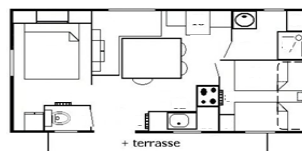

Locations : 410 / 526 / 527

### INVENTORY (common EMERALD, GARNET, RUBY and DIAMOND)

Table	Salad spinner	Dessert plates	Bowls
Chairs	Carafe	Goblets	Bread knife
Fridge	Table mat	Forks	Cutting board
Micro-waves	Can opener	Spoons	Saver
Electric coffee maker	Corkscrew	Knives	Bucket and a bowl
Stoves	Spatula	Teaspoons	Broom and shovel
Pans and 2 lids	Ladle	Carving knife	Broom, broom brush and a mop
Dishes	Skimmer	Salad bowl and salad servers	Ashtray
Saucepan	Soup plates	Glasses	Hangers
Colander	Plates	Cups	Toaster / 1 bread tongs

For any information : (0033) 4.68.80.48.10.

EMail : [camping@lesaintemarie.com](mailto:camping@lesaintemarie.com) / Site : [www.campinglesaintemarie.com](http://www.campinglesaintemarie.com)

\* Non-contractual locations

# AIR CONDITIONING



Stay in 7 nights in high season AND from 2 nights in low season

All our mobile homes are equipped with a covered terrace and a television

## LUXE « DIAMOND » - 28m<sup>2</sup> - 5 persons - TV

The +++: its air conditioning and television

**2 Bedrooms** – One room with a double bed of 140cm and one room with twin beds of 80cm and an elevated bed of 80cm.

**Kitchen** – Refrigerator of 230L + Freezer, equipped kitchen, microwave and kitchen kit.

**Stay** - Bench, table and chairs.

**Bathroom** - Shower + sink. Separated toilets.

**Outside** – Outside terrace of 20m<sup>2</sup> with garden furniture and eating space + 2 chilean

Locations : 201 / 217 / 525 / 528 / 530 / 742 / 762

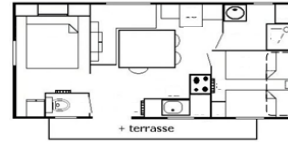

## PREMIUM « GOLD » - 32m<sup>2</sup> - 7 Persons – SALON TV

The +++: its air conditioning and television, its seating area

**2 Bedrooms** - One bedroom with a 140cm bed, one bedroom with two 80cm twin beds and an 80cm high bed and modular living room in a separate bedroom

The bedrooms are fitted with mosquito nets.

**Kitchen** - Refrigerator of 230L + Freezer, equipped kitchen, microwave and kitchen kit.

**Stay** - Bench, table, chairs, reversible air conditioning

**Bathroom** - Shower + sink. Separate WC.

**Outside** - 20m<sup>2</sup> covered outdoor terrace with dining area and garden set

Emplacements : 688 / 733

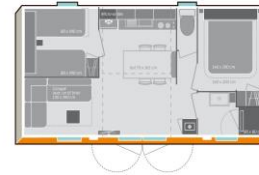

## EXCELLENCY « PLATINUM » - 34m<sup>2</sup> - 7 Persons – SALON TV

The +++: three bedrooms, covered terrace, air conditioning and television, modern kitchen, indoor and outdoor seating area

**3 Bedrooms** - A bedroom with a 140cm bed, a bedroom with two twin beds of 80cm, a bedroom with 1 pull-out bed and a loft bed

**Kitchen** - 230L fridge freezer, equipped kitchen, microwave and dishwasher.

**Living room** - table, chairs, separate lounge area reversible air conditioning

**Shower room** - Italian shower + washbasin. Separate WC.

**Outside** - Covered outdoor terrace of 24m<sup>2</sup> with bench space and garden set

Locations : 103 / 106 / 111 / 112 / 113 / 126 / 129 / 130 / 131 / 132 / 133 / 134 / 135 / 136 / 605 / 761 / 773 / 774



## INVENTORY (common EMERALD, GARNET, RUBY and DIAMOND)

Table + bench	Salad spinner	Dessert plates	Bowls
PVC Chairs	Carafe	Goblets	Bread knife
Fridge	Table mat	Forks	Cutting board
Micro-waves	Can opener	Spoons	Saver
Electric coffee maker	Corkscrew	Knives	Bucket and a bowl
Stoves	Spatula	Teaspoons	Broom and shovel
Pans and 2 lids	Ladle	Carving knife	Broom, broom brush and a mop
Dishes	Skimmer	Salad bowl and salad servers	Ashtray
Saucepan	Soup plates	Glasses and wine glasses	Hangers
Colander	Plates	Cups	Toaster / 1 bread tongs

**CLEANING FEE 100 euros**

For any information : (0033) 4.68.80.48.10.

EMail : [camping@lesaintemarie.com](mailto:camping@lesaintemarie.com) / Site : [www.campinglesaintemarie.com](http://www.campinglesaintemarie.com)

\* Non-contractual locations